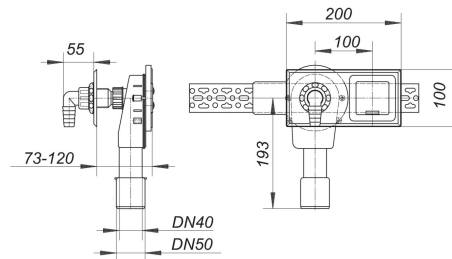

21. November 2019

DALLMER**washing machine or dishwasher trap HL 400 E, DN 40/DN 50**

Product No. **130419**
 EAN: 4001636130419
 Discount group: 1

**specification:**

- compact recessed body
- adjustable depth threaded inlet
- inlet hose connector, chrome
- sound-absorbing backing plate
- fixing bracket
- incorporating power socket with hinged cover
- cover plate stainless steel, 100 x 200 mm
- recess depth 73 - 120 mm
- spacer

material:

polyethylene trap-body for welding HDPE
 tested by: VDE (electrical connection)

If installed with only sound insulated contact against the building structure, the requirements of all classes of sound proofing confirming to DIN 4109.10, table 1 and 2 are fulfilled.

Cover plates and on/off valves can be colour-coated to customers choice.

Product No.	Description	Dimensions
140135	cleaning-eye cap for HL 400	
140173	hose connector 90° for concealed traps HL 400/405/406, chromed, 1"	1"
090324	hose connector 90°, for concealed traps HL 400/405/406, grey, 1"	1"
090348	hose connector 90°, for concealed traps HL 400/405/406, white, 1"	1"
140166	lock nut for 400/405/406, chromed, 1"	1"

21. November 2019

DALLMER

140142	lock nut for 400/405/406, grey, 1"	1"
140159	lock nut for 400/405/406, white, 1"	1"