

shower trap ORIO 60, raised grid stainless steel, DN 40

Part number: 160294
 GTIN: 4001636160294
 Rebate group: 1

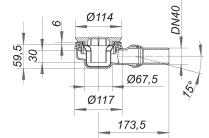

Description:

shower trap ORIO 60, raised grid stainless steel, DN 40
 extremely low build-in height (60 mm), for shower trays with a 90 mm outlet

specification

- outlet DN 40 horizontal, with ball-joint, adjustable 0 – 15 degrees
- trap insert, removable for cleaning, 40 mm water seal (deviating to DIN EN 1253)
- temporary blanking plate/installation key

material

trap polypropylene, raised grid stainless steel or ABS chromed

The outlet connector can be supplied in ABS to suit British Standard sizes and PE-HD conforming to DIN EN 1519. Please enquire.

Flow rates tested to DIN EN 274:

Nominal diameter	Product standard	Min. flow rate according to norm	Water level according to norm
DN 40	DIN EN 274	0.40 l/s	15.00 mm

Spare parts:

160706 raised grid ORIO, stainless steel

160690 trap insert ORIO 60